



**safety**

FOR SAFE  
**WORKING LIVES**

# LIFTING CHAIN SLINGS & FITTINGS

**2017 EDITION**





safety

# Contents

- 3 // **Grade 80 Lifting Chain & Fittings**
- 3 // Features & Working Load Limits (WLL)
- 4-5 // Chain Slings
- 6-8 // Links
- 9 // Connectors
- 10-11 // Clutches
- 12-13 // Hooks
- 14 // Gunnebo Shackles & Fittings
- 15 // Weld-on Excavator Hook
- 16 // **Grade 100 Lifting Chain & Fittings**
- 16 // Features & Working Load Limits (WLL)
- 16 // Lifting Chain
- 17-18 // Chain Slings
- 19-20 // Links
- 21 // Connectors
- 22-24 // Hooks
- 25-26 // Lifting and Lashing Rings
- 27 // **RUD ICE Grade 120 Lifting Chain & Fittings**
- 27 // Features & Working Load Limits (WLL)
- 28 // Chain Slings
- 30 // **Cromox Grade 60 Stainless Steel Chain Slings**
- 30-33 // Chain Slings
- 34-36 // Clevis Hooks, Eye Hooks & Accessories

# GRADE 80 LIFTING CHAIN & FITTINGS



## Grade 80(T) Lifting Chain

Grade 80(T) Chain is manufactured from heat treated alloy steel, and is ideal for heavy duty lifting applications. It meets Australian standards AS 2321, Short-Link Chain for Lifting Purposes and is high strength, rugged, versatile and low-weight.

- Quality testing is undertaken throughout the manufacturing process
- Grade 80 Chain also carries the mark "BSN-8", stamped at intervals along its entire length for easy identification.

## Grade 80 Components

Grade 80 Lifting Components are also manufactured from heat treated alloy steel and are ideal for heavy duty lifting applications. All components meet Australian Standards AS 2321, Short-Link Chain and Components for Lifting Purposes.

- Quality testing is undertaken throughout the manufacturing process
- Grade 80 Components also carry distinguishing marks – see below image 1.1.

### 1.1 Grade 80 Markings

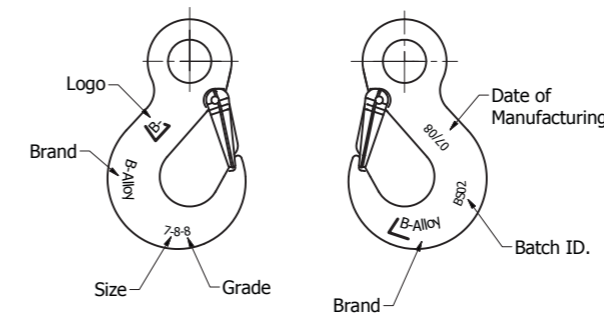

## Working Load Limits Grade 80

Chain Size (mm)	Single Leg Slings			2,3 or 4 Leg Slings						Endless Slings			
	Straight Sling	Adjustable Sling	Reeved Sling	Straight Sling			Reeved Sling			Basket Sling			Reeved Sling
	60°	90°	120°	60°	90°	120°	60°	90°	120°	60°	90°	120°	
6	1.1	1.1	0.80	1.9	1.6	1.1	1.5	1.2	0.8	1.5	1.2	0.8	1.7
8	2.0	2.0	1.5	3.5	2.8	2.0	2.6	2.1	1.5	2.6	2.1	1.5	3.0
10	3.2	3.2	2.4	5.5	4.5	3.2	4.1	3.4	2.4	4.1	3.4	2.4	4.8
13	5.3	5.3	4.0	9.2	7.5	5.3	6.9	5.6	4.0	6.9	5.6	4.0	8.0
16	8.0	8.0	6.0	13.8	11.3	8.0	10.4	8.5	6.0	10.4	8.5	6.0	12.0
20	12.5	12.5	9.4	21.6	17.6	12.5	16.3	13.3	9.4	16.3	13.3	9.4	18.8
22	15.0	15.0	11.3	26.0	21.2	15.0	19.5	15.9	11.3	19.5	15.9	11.3	22.5
26	21.2	21.2	15.9	36.7	29.9	21.2	27.6	22.5	15.9	27.6	22.5	15.9	31.8
32	31.5	31.5	23.6	54.5	44.4	31.5	41.0	33.4	23.6	41.0	33.4	23.6	47.3

Working load limit in tonnes of 1000kg under general conditions of use. Some grab hooks derate the W.L.L by 25%. Shortening hooks and cradle grab hooks may not derate the W.L.L. Advice should be sought from the manufacturer.

## Grade 80 Chain Slings With Shorteners and Self Locking Hooks



Size (mm)	Length (m)	1 Leg Product Code	1 Leg WLL (t)	2 Leg Product Code	3 Leg Product Code	4 Leg Product Code	2,3,4 Leg WLL (t)
6	3	08061123	1.1	08062123	08063123	08064123	1.9
6	6	08061126	1.1	08062126	08063126	08064126	1.9
8	3	08081123	2.0	08082123	08083123	08084123	3.5
8	6	08081126	2.0	08082126	08083126	08084126	3.5
10	3	08101123	3.2	08102123	08103123	08104123	5.5
10	6	08101126	3.2	08102126	08103126	08104126	5.5
13	3	08131123	5.3	08132123	08133123	08134123	9.2
13	6	08131126	5.3	08132126	08133126	08134126	9.2
16	3	08161123	8.0	08162123	08163123	08164123	13.8
16	6	08161126	8.0	08162126	08163126	08164126	13.8
20	3	08201123	12.5	08202123	08203123	08204123	21.6
20	6	08201126	12.5	08202126	08203126	08204126	21.6
22	3	08221123	15.0	08222123	08223123	08224123	26.0
22	6	08221126	15.0	08222126	08223126	08224126	26.0
26	3	08261123	21.2	08262123	08263123	08264123	36.7
26	6	08261126	21.2	08262126	08263126	08264126	36.7
32	3	08321123	31.5	08322123	08323123	08324123	54.5
32	6	08321126	31.5	08322126	08323126	08324126	54.5

\*Other lengths and configurations available upon request.



1 Leg Chain Sling With Shorteners and Self Locking Hooks



2 Leg Chain Sling With Shorteners and Self Locking Hooks



1 Leg Chain Sling With Shorteners and Safety Hooks



2 Leg Chain Sling With Shorteners and Safety Hooks



3 Leg Chain Sling With Shorteners and Self Locking Hooks



4 Leg Chain Sling With Shorteners and Self Locking Hooks



3 Leg Chain Sling With Shorteners and Safety Hooks



4 Leg Chain Sling With Shorteners and Safety Hooks

## Grade 80 Chain Slings With Shorteners and Safety Hooks

Size (mm)	Length (m)	1 Leg Product Code	1 Leg WLL (t)	2 Leg Product Code	3 Leg Product Code	4 Leg Product Code	2,3,4 Leg WLL (t)
6	3	08061113	1.1	08062113	08063113	08064113	1.9
6	6	08061116	1.1	08062116	08063116	08064116	1.9
8	3	08081113	2.0	08082113	08083113	08084113	3.5
8	6	08081116	2.0	08082116	08083116	08084116	3.5
10	3	08101113	3.2	08102113	08103113	08104113	5.5
10	6	08101116	3.2	08102116	08103116	08104116	5.5
13	3	08131113	5.3	08132113	08133113	08134113	9.2
16	6	08161116	5.3	08162116	08163116	08164116	9.2
20	3	08201113	8.0	08202113	08203113	08204113	13.8
20	6	08201116	8.0	08202116	08203116	08204116	13.8
22	3	08221113	12.5	08222113	08223113	08224113	21.6
22	6	08221116	12.5	08222116	08223116	08224116	21.6
26	3	08261113	15.0	08262113	08263113	08264113	26.0
26	6	08261116	15.0	08262116	08263116	08264116	26.0
32	3	08321113	21.2	08322113	08323113	08324113	36.7
32	6	08321116	21.2	08322116	08323116	08324116	36.7
32	3	08321123	31.5	08322123	08323123	08324123	54.5
32	6	08321126	31.5	08322126	08323126	08324126	54.5

\*Other lengths and configurations available upon request.

## Grade 80(T) Chain

Grade 80(T) Alloy Chain to AS2321\*

Safety Factor 4:1

Product Code	Size (mm)	S (mm)	R (mm)	F (mm)	WLL (t)	UOM	Metres Per 100kg
148006	6	6	18	22.2	1.2	Metre	115
148007	7	7	21	25.9	1.6	Metre	90
148008	8	8	24	29.6	2	Metre	71
148010	10	10	30	37	3.2	Metre	45
148013	13	13	39	48.1	5.4	Metre	26
148016	16	16	48	59.2	8.2	Metre	17
148020	20	20	60	74	12.8	Metre	11
148022	22	22	66	81.4	16	Metre	9
148026	26	26	78	96.2	20.6	Metre	6
148032	32	32	96	118	32.8	Metre	4

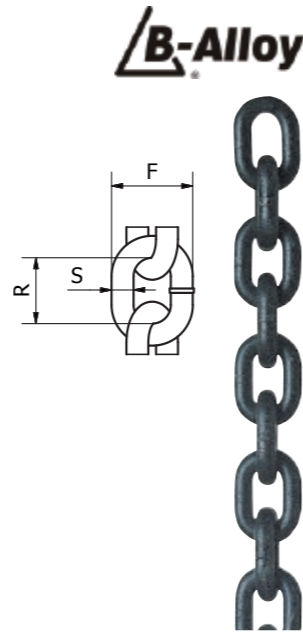

## Grade 80 Master Links

Grade 80 Recessed Enlarged Master Oblong Link (M)\*

Product Code	Chain Size (mm)		WLL (kg)	S (mm)	R (mm)	F (mm)	T (mm)	Approx Weight (kg)	UOM	Pack Qty
	1 Leg	2 Leg								
883508A	8	7	2700	15.5	120	70	7	0.44	Each	60
883510A	10	8	3500	18	140	80	7	0.67	Each	25
883513A	13	10	5500	22.5	160	95	11	1.52	Each	16
883516A	16	13	9400	29	190	110	13	2.65	Each	8
883520A	20	16	14200	35	230	130	16	4.48	Each	6
883522A	22	20	22300	42	275	150	22	7.49	Each	3
883526A	26	22	33500	50	340	180	28	12.83	Each	2
883532A	32	26	40800	55	350	190	30	16.56	Each	1
883536A	36	32	56800	62	400	200	36	31.02	Each	1

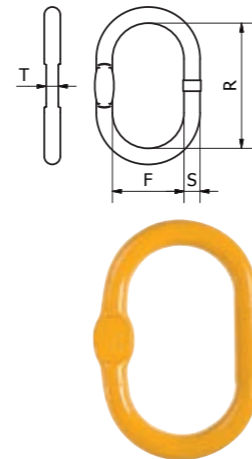

\*Designed for Single & 2 Leg Applications

## Grade 80 Clevis Single Master Link (BCM)



Product Code	Chain Size (mm)	WLL (kg)	e (mm)	b (mm)	h (mm)	h2 (mm)	d (mm)	f (mm)	s (mm)	Approx Weight (kg)	UOM	Pack Qty
882007	8	3500	138	92	163.7	105	9.7	9	16	0.7	Each	1
882010	10	5500	167	111	197	128	12	12	18	1.2	Each	1
882013	13	9200	203	134	241	150	16	15	22	2.3	Each	1
882016	16	13800	230	152	276	165	20	18	26	3.8	Each	1

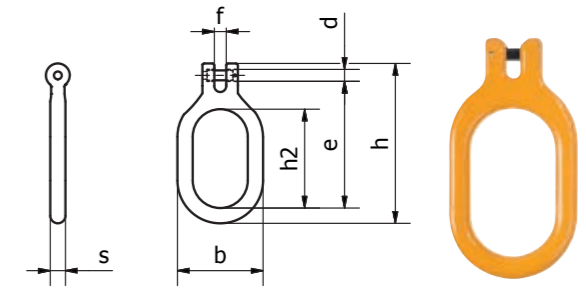

## Grade 80 Recessed Enlarged Multi-Leg Master Oblong Link\*

Product Code	Chain Size (mm)	WLL @60° (kg)	S (mm)	R (mm)	F (mm)	T (mm)	E (mm)	s (mm)	r (mm)	f (mm)	t (mm)	Approx Weight (kg)	UOM	Pack Qty
883707	7	3150	19	135	75	-	195	13	60	38	8	1.35	Each	1
883708	8	4250	23	160	90	-	230	16	70	34	8	2.32	Each	1
883710	10	6700	27	180	100	-	265	18	85	40	11.5	3.58	Each	1
883713	13	11200	33	200	110	-	315	23	115	50	14	6.57	Each	1
883716	16	17000	36	260	140	-	400	27	140	65	18	10.3	Each	1
883720	19-20	26500	45	340	180	-	490	33	150	70	-	19.3	Each	1
883722	22	31500	50	350	190	-	520	36	170	75	-	25.1	Each	1
883726	26	45000	56	400	200	-	570	40	170	80	-	34.3	Each	1
883732	32	56800	70	460	250	-	660	50	200	100	-	64	Each	1

Designed for 2, 3 and 4 Leg Applications

Please Also Note: Australian Standards only allow for 2 legs to be considered as the maximum load.

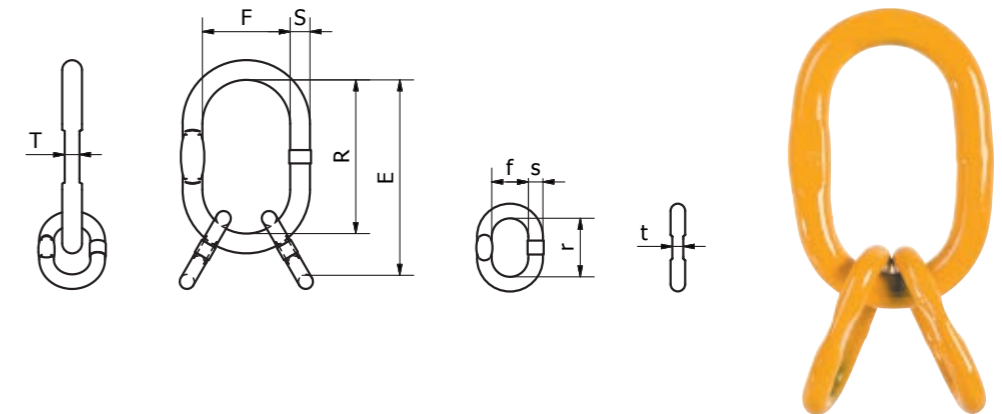

\*Most popular Grade 80 fittings

## Grade 80 (T) Herc Alloy 800™ Chain to AS2321

Product Code	Chain Size (mm)	S (mm)	R (mm)	F (mm)	WLL (t)	kg/100m
40135	6.0	6.3	20.8	22.3	1.1	85.2
40136	7.1	7.1	23.8	25.9	1.6	114.0
40959	8.0	8.0	23.8	27.0	2.0	140.0
40137	10.0	9.7	29.8	33.8	3.2	208.0
40138	13.0	12.7	38.0	43.0	5.3	349.0
40139	16.0	16.0	47.8	54.0	8.0	564.0
40140	20.0	20.0	59.2	67.5	12.5	878.0
40141	22.0	22.0	65.0	74.2	15.0	1066.0
41256	26.0	26.0	78.0	96.2	21.2	1510.0
40143	32.0	32.0	96.0	112.0	31.5	2300.0

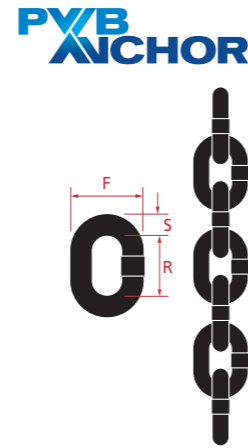

### PWB Large Series Oblong Link

Wider and longer, the Large Series Oblong Link is designed for use in both single and 2-leg applications.

\* Includes standard markings of either PWB-HA800 or PWB-HA8 (6–26mm sizes)

Product Code	Chain Size 1 Leg	Chain Size 2 Leg	WLL (t)	H (mm)	J (mm)	K (mm)	Mass (mm)
40617	6-7.1	-	1.6	130	70	13	0.4
40618	8-10	7.1-8	3.5	135	70	16	0.7
40619	13	10	5.5	200	100	22	1.7
40620	16	13	9.2	240	120	30	3.8
40621	20	16	13.8	280	140	33	5.4
40622	22	20	21.6	300	150	39	8.5
40623	26	22	26	330	165	42	10.5
40624	32	26	36.7	360	180	48	15
41767	32	32	54.5	431	231	60	30

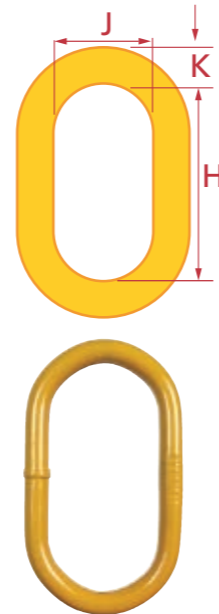

### PWB Anchor Oblong Links

#### PWB Anchor Regular Series Oblong Link

The range of Herc-Alloy Oblong Links allows for greater flexibility in selection and construction of chain sling or wire rope assemblies.

• Includes standard markings of either PWB-HA800 or PWB-HA8

\*Designed for both single and 2-leg applications

Product Code	Chain Size 1 Leg	Chain Size 2 Leg	WLL (t)	H (mm)	J (mm)	K (mm)	Mass (kg)
40490	6-10	6-8	3.5	88	44	13	0.3
40491	13	10	5.5	114	57	20	0.9
40492	16	13	9.2	130	70	22	1.2
40493	20	16	13.8	160	80	30	2.7
40494	22	20	21.6	180	90	33	3.7
40495	26	22	26.0	200	100	39	5.5



\*Most popular Grade 80 fittings

## Grade 80 Connectors\*

### Grade 80 Component Connector (C)\*

Product Code	Chain Size (mm)	WLL (kg)	e (mm)	c (mm)	b (mm)	g (mm)	d (mm)	s (mm)	Approx Weight (kg)	UOM	Pack Qty	Replacement Pin and Stud Kit
C6	6	1100	18	7	45	18	7.7	10.5	0.07	Each	20	894206BA
C7	7	1500	19	8.3	52	19	9	12.3	0.1	Each	30	894207BA
C8	8	2000	23	9.5	65	23	10.5	13.5	0.25	Each	20	894208BA
C10	10	3200	27	12	73	27	12.9	17.2	0.35	Each	30	894210BA
C13	13	5300	34	16	88	34	16.8	22.7	0.68	Each	20	894213BA
C16	16	8000	39	19	103	39	20.6	28	1.1	Each	12	894216BA
C20	20	12500	47	23.5	116	47	25.8	34.8	2.2	Each	8	894220BA
C22	22	15000	55	26.5	133	55	28.3	35.5	2.72	Each	6	894222BA
C26	26	21200	66	31.5	148	66	33.4	42	5.05	Each	4	894226BA
C32	32	31500	79	38	183	79	40.8	51	10.02	Each	2	894232BA

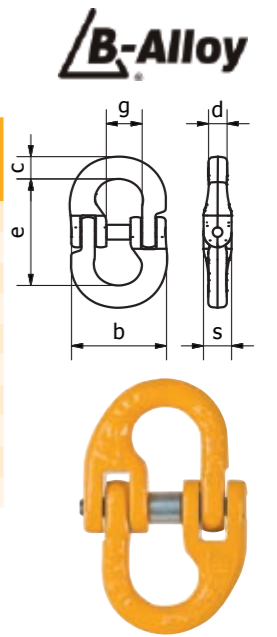

### Grade 80 Clevis Shortening Grab Hook (BSG)\*

Product Code	Chain Size (mm)	WLL (kg)	e (mm)	b (mm)	d (mm)	g (mm)	Approx Weight (kg)	UOM	Pack Qty
886206	6	1100	45	45.7	7.6	8.3	0.25	Each	80
886207	7-8	2000	53.3	50	9	10.5	0.28	Each	55
886210	10	3200	75.5	72	12.5	10.5	0.73	Each	25
886213	13	5300	92	96	16	16.5	1.6	Each	12
886216	16	8000	99	112.5	19.7	19	2.8	Each	8
886220	20	12500	122.7	143	24	24	4	Each	4
886222	22	15000	126	143.5	26	27	72	Each	3

No Deration

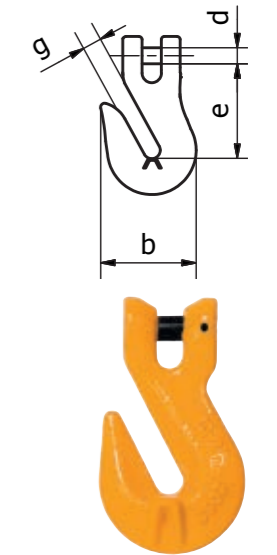

### Grade 80 Clevis Shortening Grab Hook c/w Safety Pin

Product Code	Chain Size (mm)	WLL (kg)	e (mm)	b (mm)	d (mm)	g (mm)	Approx Weight (kg)	UOM	Pack Qty
886213S	13	5300	90	120	16	15	1.75	Each	1
886216S	16	8000	105	130	20	19	2.8	Each	1

No Deration

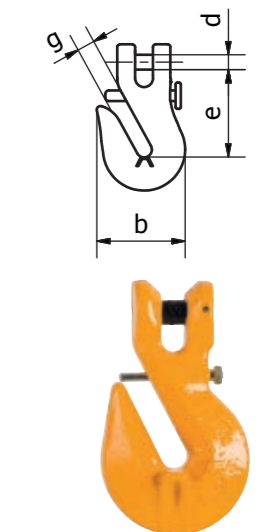

\*Most popular Grade 80 fittings

## Grade 80 Clevis Clutch – Locking Type



Product Code	Chain Size (mm)	WLL (kg)	c (mm)	f (mm)	g (mm)	e (mm)	a (mm)	k (mm)	Approx Weight (kg)	UOM	Pack Qty
884510SY	10	3150	12	12	12	66	12	28	0.9	Each	1
884513SY	13	5300	16	15	15	88	16	39	2.1	Each	1
884516SY	16	8000	19	21	18	103	19	48	3.7	Each	1

No Deration

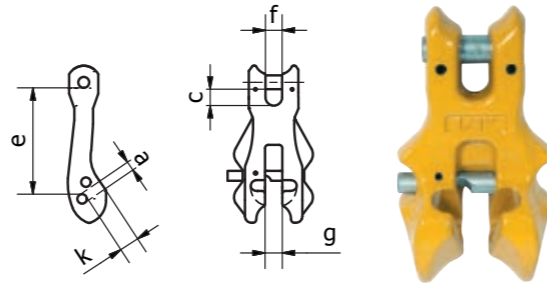

## Grade 80 Clevis Shortening Clutch (BCC)

Product Code	Chain Size (mm)	WLL (kg)	c (mm)	f (mm)	d (mm)	g (mm)	e (mm)	h (mm)	a (mm)	k (mm)	Approx Weight (kg)	UOM	Pack Qty
884507	7-8	2000	10	9	9	8	50	99	9	12	0.4	Each	1
884510	10	3200	14	12	13	12	74	135	12	25	0.9	Each	1
884513	13	5400	17	17	16	16	82	175	16	30	2.1	Each	1

No Deration

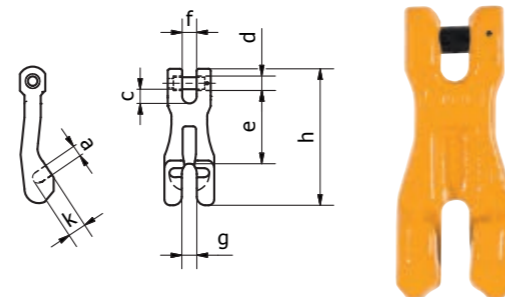

## Grade 80 Clevis Choker Hook (BCH)

Product Code	Chain Size (mm)	WLL (kg)	a (mm)	b (mm)	c (mm)	d (mm)	e (mm)	f (mm)	g (mm)	h (mm)	d2 (mm)	w (mm)	Approx Weight (kg)	UOM	Pack Qty
888807	7-8	2000	35.5	73	12.5	9.2	59.5	9.5	9.8	95.5	20	18	0.4	Each	40
888810	10	3200	45	98	16	12	80.5	13	13	137	24	22	0.9	Each	20
888813	13	5300	53.5	119	14	16	95	16	16	165	30	30	1.75	Each	10

No Deration

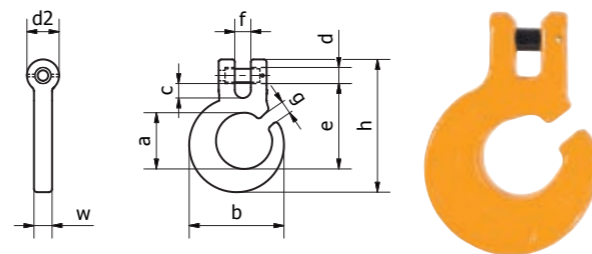

\*Most popular Grade 80 fittings

## Grade 80 Clevis Self Locking Safety Hook (BCSL)\*



Product Code	Chain Size (mm)	WLL (kg)	e (mm)	d (mm)	h (mm)	b (mm)	g (mm)	Approx Weight (kg)	UOM	Pack Qty	Replacement Trigger Kit
886406Y	6	1100	98	8	22	75	28	0.57	Each	35	896506
886407Y	7-8	2000	120	10	25	86	33	0.91	Each	25	896508
886410Y	10	3200	150	12.5	34	111	45	1.675	Each	12	896510
886413Y	13	5300	185	16	40	136	52	3.33	Each	6	896513
886416Y	16	8000	215	20	53	173	64	6	Each	4	896516
886420Y	20	12500	235	24	64	200	77	8.6	Each	3	896520
886422Y	22	15000	255	28	74	229	92	14.7	Each	1	896522
886426Y	26	21200	316	34	85	256	97	23.5	Each	1	896526

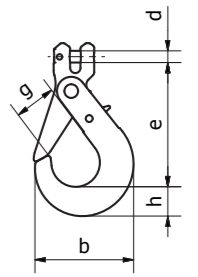

## Grade 80 Clevis Sling Hook with Safety Latch (BSS)\*

Product Code	Chain Size (mm)	WLL (kg)	e (mm)	d (mm)	h (mm)	b (mm)	g (mm)	Approx Weight (kg)	UOM	Pack Qty	Replacement Latch Kit
885106	6	1100	76.4	7.8	20	77.4	27	0.23	Each	50	895106BA
885107	7-8	2000	86	9.3	25	85	26	0.48	Each	30	895107BA
885110	10	3200	104	13	31	103	33.5	0.95	Each	18	895110BA
885113	13	5300	127.8	16.4	42.5	127.5	40	1.85	Each	10	895113BA
885116	16	8000	148	21.3	54	161	51	3.94	Each	5	895116BA
885120	20	12500	179	24.3	58	188	59	6.36	Each	2	895120BA
885122	22	15000	215	26.3	60.4	229	79	10.4	Each	2	895122BA

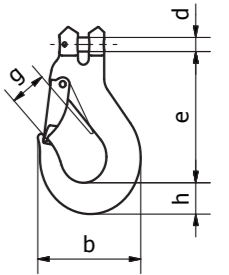

\*Most popular Grade 80 fittings

## Grade 80 Hooks



### Grade 80 Eye Shortening Grab Hook (BEG)\*

Product Code	Chain Size (mm)	WLL (kg)	e (mm)	b (mm)	d1 (mm)	d2 (mm)	g (mm)	Approx Weight (kg)	UOM	Pack Qty
885306	6	1100	51	45.8	13.5	8	8.3	0.14	Each	100
885307	7-8	2000	61.7	51	18	9.5	10.8	0.35	Each	80
885310	10	3200	80	70	20.5	13	13.5	0.65	Each	30
885313	13	5300	99.7	89.7	26	15.5	16.5	1.39	Each	15
885316	16	8000	105.5	113	30.5	19	20	2.1	Each	8
885320	20	12500	140.7	143	37.5	23	25	4	Each	5
885322	22	15000	165	160.5	44	26	28	6.36	Each	3
885326	26	21200	188.5	181.3	44	34	30	9.6	Each	2
885332	32	31500	230	223	57	40	38	19.4	Each	1

No Deration

### Grade 80 Eye Sling Hook with Safety Latch (BEL)\*

Product Code	Chain Size (mm)	WLL (kg)	e (mm)	b (mm)	h (mm)	d1 (mm)	d2 (mm)	g (mm)	Approx Weight (kg)	UOM	Pack Qty	Replacement Latch Kit
885806	6	1100	75	71.3	19	20	10	23.5	0.244	Each	50	895806BA
885807	7-8	2000	111	82	23	23	11	30	0.4	Each	30	895807BA
885810	10	3200	120	109.5	31	38	15	34	0.9	Each	18	895810BA
885813	13	5300	152	146.5	44.5	43	19	39	2.35	Each	10	895813BA
885816	16	8000	184	154	44	50	23	46	3.2	Each	5	895816BA
885820	20	12500	219	198	58.5	62	24	48	5.8	Each	3	895820BA
885822	22	15000	271	259	75.5	62	32	71	8.5	Each	2	895822BA
885826	26	21200	279	262.8	80.5	64	35	81	13	Each	1	895826BA
885832	32	31500	373	355	88	88	37	102	17	Each	1	895832BA

### Grade 80 Eye Self Locking Safety Hook (BSL)\*

Product Code	Chain Size (mm)	WLL (kg)	e (mm)	d1 (mm)	d2 (mm)	h (mm)	b (mm)	g (mm)	Approx Weight (kg)	UOM	Pack Qty	Replacement Latch Kit
885706Y	6	1100	107	22	11	22	75	28	0.5	Each	35	896506
885707Y	7-8	2000	133	24	11	25	86	33	0.84	Each	25	896508
885710Y	10	3200	167	32	15.5	34	111	45	1.575	Each	12	896510
885713Y	13	5300	208	39	20.5	40	136	52	3.12	Each	6	896513
885716Y	16	8000	254	49	24.5	53	173	64	5.875	Each	4	896516
885720Y	20	12500	272	59	27.5	64	200	77	8.5	Each	3	896520
885722Y	22	15000	310	70	35	74	229	92	14.3	Each	1	896522
885726Y	26	21200	363	80	34	75	242.8	99	18	Each	1	885726YK
885732Y	32	31500	472	105	45	97	334	147	44.5	Each	1	885732YK

### Grade 80 Eye Foundry Hook (BEF)

Product Code	Chain Size (mm)	WLL (kg)	e (mm)	d1 (mm)	d2 (mm)	h (mm)	b (mm)	g (mm)	Approx Weight (kg)	UOM	Pack Qty
885607	7-8	2000	121.7	18	12	31.2	120.8	63	1.09	Each	12
885610	10	3200	147.5	22	16	36.5	146	76	1.95	Each	8
885613	13	5300	175.6	27	19	44.5	171	89	3.22	Each	5
885616	16	8000	205	32	20	52	198	102	5.26	Each	3
885620	20	12500	232	38	25.4	65	232	114.5	9.07	Each	2
885622	22	15000	263	45	28.7	69	256	127.5	11.79	Each	1

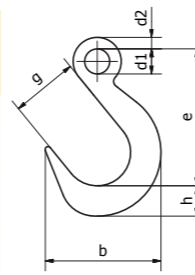
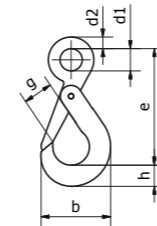
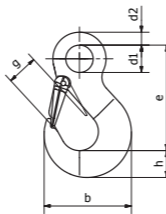
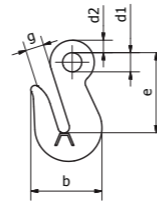

\*Most popular Grade 80 fittings

### Grade 80 Eye Swivel Hook with Safety Latch (BSH)



Product Code	Chain Size (mm)	WLL (kg)	e (mm)	d2 (mm)	h (mm)	g (mm)	w (mm)	Approx Weight (kg)	UOM	Pack Qty	Replacement Latch Kit
885407	7-8	2000	164	14	28	25	34	0.93	Each	15	895407
885410	10	3200	187	16	36	29	42	1.75	Each	8	895410
885413	13	5300	245	20	45	40	52	3.4	Each	7	895413
885416	16	8000	286	23	48	47	60	6.025	Each	4	895416

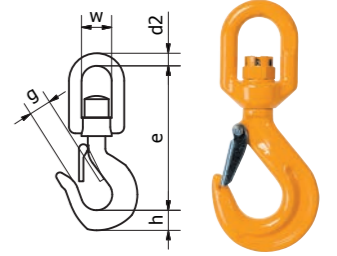

### Grade 80 Eye Swivel Self Locking Safety Hook (BLS)

(Swivels under load)

Product Code	Chain Size (mm)	WLL (kg)	e (mm)	d2 (mm)	h (mm)	g (mm)	w (mm)	Approx Weight (kg)	UOM	Pack Qty	Replacement Latch Kit
886507	7-8	2000	189	14	25	33	34	1.2	Each	15	896508
886510	10	3200	229	16	34	45	42	2.23	Each	8	896510
886513	13	5300	285	22	40	52	52	4.27	Each	6	896513
886516	16	8000	335	23	53	67	60	7.75	Each	3	896516
886520	20	12500	375	27	64	77	74	11.9	Each	2	896520

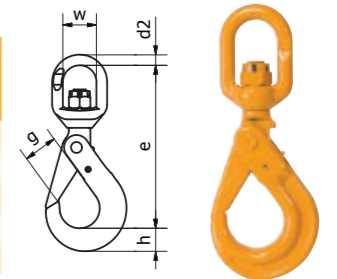

### Grade 80 Eye Swivel Self Locking Safety Hook c/w Ball Bearing (BLS)

(Swivels under load)

Product Code	Chain Size (mm)	WLL (kg)	e (mm)	d2 (mm)	h (mm)	g (mm)	w (mm)	Approx Weight (kg)	UOM	Pack Qty	Replacement Latch Kit
886606	6	1100	163.3	11.5	19	27	32.5	0.71	Each	25	896606
886607	7-8	2000	195	13	26	35	36	1.1	Each	18	896607
886610	10	3200	237	15.5	30	44	42	2	Each	10	896610
886613	13	5300	282	17	27	53	50	4	Each	4	896613
886616	16	8000	341.5	21.5	48	60	61	7.3	Each	2	896616
886620	20	12500	399.5	26.5	61	87	76	11.6	Each	1	896620

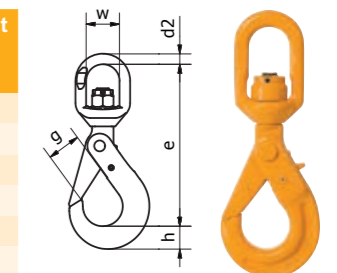

### Grade 80 Eye Container Hook (KA)

Product Code	Dsc.	WLL (kg)	A (mm)	R (mm)	D (mm)	h (mm)	F (mm)	E (mm)	L (mm)	Approx Weight (kg)	UOM	Pack Qty
886845L	Left 45°	12500	46	60	70	25	75	48	240	4	Each	2
886845R	Right 45°	12500	46	60	70	25	75	48	240	4	Each	2

Approved for container lifting as part of an assembly

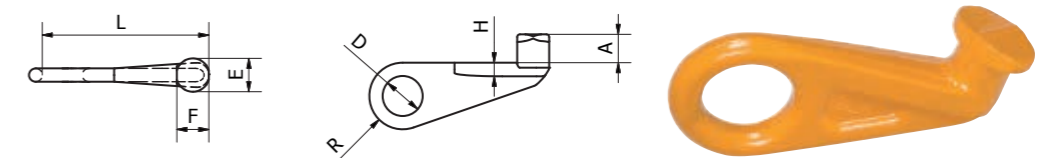

\*Most popular Grade 80 fittings

## GUNNEBO Shackles & Fittings



### GUNNEBO Grade 80 Clevis Shackle GSA

Product Code	WLL (t)	For Chain Dim (mm)	B (mm)	C (mm)	G (mm)	L (mm)	M (mm)	Weight (kg)
GSA-7/8-8	2	7,8	32	36	34	60	16	0.4
GSA-10-8	3.15	10	34	48	40	80	20	0.8
GSA-13-8	5.3	13	50	65	44	98	22	1.4
GSA-16-8	8	16	60	70	54	114	27	2.4

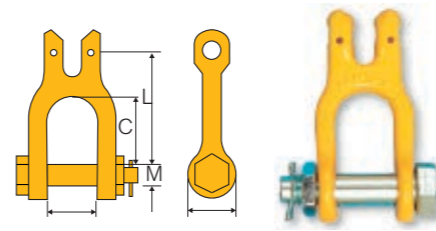

### GUNNEBO Grade 80 Roller-bearing Swivel SKLI/SKLU

Insulated

Product Code	WLL (t)	For Chain Dim (mm)	L (mm)	D (mm)	Weight (kg)
SKLI-7/8-8	2	7,8	75	48	0.7
SKLI-10-8	3.2	10	96	59	1.3
SKLI-13-8	5.4	13	120	75	2.8
SKLI-16-8	8	16	137	90	4.6
SKLI-18/20-8	12.5	19	159	104	7.3
SKLU-22-8*	15.5	22	160	109	9.2
SKLU-26-8*	21.6	26	207	135	18.3



\*Uninsulated

### GUNNEBO Grade 80 Roundsling Coupling SKR

Specialised shaped for full WLL of the roundsling.

Product Code	WLL (t)	L (mm)	B (mm)	K (mm)	Weight (kg)
SKR-7/8-8	2.0	35	40	18	0.212
SKR-10-8	3.2	42	47	24	0.379
SKR-13-8	5.4	50	53	29	0.651
SKR-16-8	8.0	62	67	35	1.233
SKR-18/20-8 12.5		71	80	43	2.018
SKR-22-8	15.5	111	125	50	5.233
SKR-26-8	21.6	129	150	58	8.825

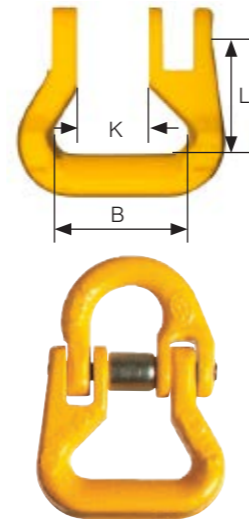

### GUNNEBO Grade 80 Half link SKT (incl. locking set)

Product Code	WLL (t)	For Chain Dim (mm)	L (mm)	B (mm)	G (mm)	E (mm)	Weight (kg)
SKT-7/8-8	2	7,8	28	18	9	22	0.1
SKT-10-8	3.2	10	34	25	12	26	0.2
SKT-13-8	5.4	13	44	29	15	33	0.4
SKT-16-8	8	16	52	36	19	40	0.6
SKT-18/20-8	12.5	19	63	43	22	48	1.1
SKT-22-8	15.5	22	76	50	24	60	1.7
SKT-26-8	21.6	26	80	58	29	61	2.6
SKT-32-8	32	32	100	70	36	78	4.9

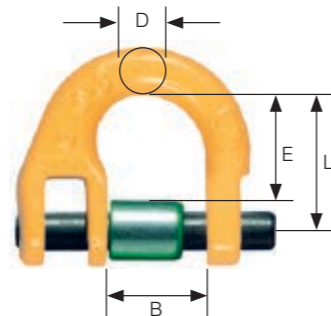

\*Most popular Grade 80 fittings

## Grade 80 Weld-on Safety Excavator Hook (BWH)



Product Code	WLL (kg)	b (mm)	g (mm)	L1 (mm)	L2 (mm)	w (mm)	Approx Weight (kg)	Replacement Latch Kit	UOM	Pack Qty
886701A	1000	53	18	87	55	20	0.35	Each	30	896701
886703A	3000	106	30.5	129	86	36	1.2	Each	15	896703
886705A	5000	133	34	171	118.5	43.5	2.46	Each	8	896705
886708	8000	136.5	34	177	118.5	51	3.26	Each	6	896708
886710	10000	169.5	51	223	154	53	5.17	Each	4	896710

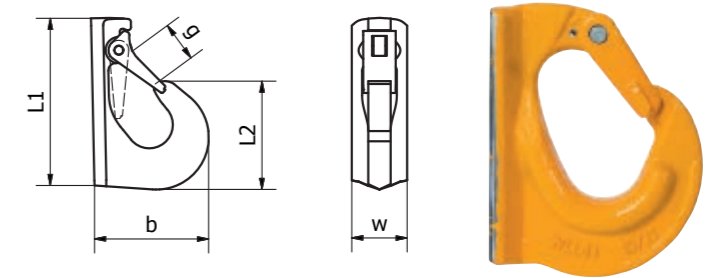

\*Most popular Grade 80 fittings





# GRADE 100 CHAIN & FITTINGS

## BV-100 Lifting Chain

Our BV-100 Grade 100 chain complies with Australian Standard AS 2321.

- Rugged, versatile, high strength and low-weight
- BV-100 Grade 100 Chain carries the mark "10" stamped on every link along its entire length for easy identification
- Sizes available from 6-26mm.

## BV-100 Lifting Fittings

BV-100 Grade 100 Lifting Fittings also comply with Australian Standard AS 2321.

## BV-100 Grade 100 Markings

Sizes available: 6mm-26mm.

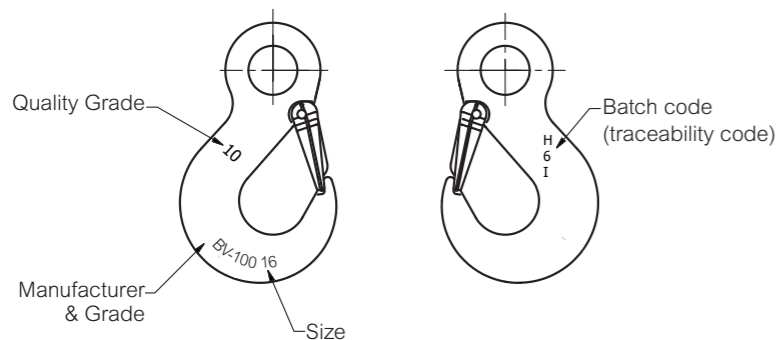

## Working Load Limits Grade 100

Chain Size (mm)	Single Leg Slings			2,3 or 4 Leg Slings						Endless Slings			
	Straight Slings	Adjustable Slings	Reeved Slings	Straight Slings			Reeved Slings			Basket Slings		Reeved Slings	
				60°	90°	120°	60°	90°	120°	60°	90°	120°	
6	1.4	1.4	1.0	2.4	2.0	1.4	1.8	1.4	1.0	1.8	1.4	1.0	2.1
8	2.5	2.5	1.9	4.3	3.5	2.5	3.2	2.6	1.9	3.2	2.6	1.9	3.7
10	4.0	4.0	3.0	6.9	5.6	4.0	5.2	4.2	3.0	5.2	4.2	3.0	6.0
13	6.7	6.7	5.0	11.5	9.5	6.7	8.7	7.1	5.0	8.7	7.1	5.0	10.0
16	10.0	10.0	7.5	17.3	14.1	10.0	13.0	10.6	7.5	13.0	10.6	7.5	15.0
20	16.0	16.0	12.0	27.7	22.5	16.0	20.8	17.0	12.0	20.8	17.0	12.0	24.0
22	19.0	19.0	14.2	32.9	26.5	19.0	24.7	21.0	14.2	24.7	20.1	14.2	28.5
26	26.5	26.5	19.8	45.8	37.3	26.5	34.4	28.0	19.8	34.4	28.0	19.8	39.7

Working load limit in tonnes of 1000kg under general conditions of use. Some grab hooks derate the W.L.L. by 25%. Shortening hooks and cradle grab hooks may not derate the W.L.L. Advice should be sought from the manufacturer.

## BV-100 Chain Slings

Bunzl Safety can provide all inclusive pre-made chain slings complete with shorteners and hooks for your convenience.

The length of each chain leg can be altered by using the shortener.

### Features

- Superior resistance to wear
- Pre-made for convenience
- Complete with shorteners
- 25% higher load capacity over Grade 80
- 30% weight saving over Grade 80
- BV-100 Grade 100 chain meets and exceeds the requirements of ASTM A973/A973m-01 and EN818-2
- All fittings meet EN1677.

## Standard Grade 100 Chain Slings With Shorteners and Self Locking Hooks\*

Size (mm)	Length (m)	1 Leg Product Code	1 Leg WLL (t)	2 Leg Product Code	2, 3, 4 Leg WLL (t)
8	3	Special Order	2.5	?	4.3
8	6	Special Order	2.5	?	4.3
10	3	Special Order	4.0	?	6.9
10	6	Special Order	4.0	?	6.9
13	3	Special Order	6.7	?	11.5
13	6	Special Order	6.7	?	11.5
16	3	Special Order	10.0	?	17.3
16	6	Special Order	10.0	?	17.3
20	3	Special Order	16.0	?	27.7
20	6	Special Order	16.0	?	27.7
22	3	Special Order	19.0	?	32.9
22	6	Special Order	19.0	?	32.9
26	3	Special Order	26.5	?	45.8
26	6	Special Order	26.5	?	45.8
32	3	Special Order	40.0	?	69.2
32	6	Special Order	40.0	?	69.2

Note: Other 1,2,3 and 4 leg chain slings are available by special order



1 Leg Chain Sling With Shorteners and Self Locking Hooks



2 Leg Chain Sling With Shorteners and Self Locking Hooks



3 Leg Chain Sling With Shorteners and Self Locking Hooks



4 Leg Chain Sling With Shorteners and Self Locking Hooks

\*Most popular Grade 100 fittings

Standard Grade 100 Chain Slings With Shorteners and Safety Hooks\*

Size (mm)	Length (m)	1 Leg Product Code	1 Leg WLL (t)	2 Leg Product Code	2, 3, 4 Leg WLL (t)
8	3		2.5	0855G10823	4.3
8	6		2.5	0855G10826	4.3
10	3		4.0	0855G11023	6.9
10	6		4.0	0855G11026	6.9
13	3		6.7	0855G11323	11.5
13	6		6.7	0855G11326	11.5
16	3		10.0	0855G11623	17.3
16	6		10.0	0855G11626	17.3
20	3		16.0	0855G12023	27.7
20	6		16.0	0855G12026	27.7
22	3		19.0	0855G12223	32.9
22	6		19.0	0855G12226	32.9
26	3		26.5	0855G12623	45.8
26	6		26.5	0855G12626	45.8

Note: Other 1,2,3 and 4 leg chain slings are available by special order



1 Leg Chain Sling With Shorteners and Safety Hooks



2 Leg Chain Sling With Shorteners and Safety Hooks



3 Leg Chain Sling With Shorteners and Safety Hooks



4 Leg Chain Sling With Shorteners and Safety Hooks

BV-100 Grade 100 Chain\*

Features

- 25% higher load capacity than Grade 80
- 30% weight saving over Grade 80
- Enlarged head rings to eliminate the need for shackles (for fitting slings onto large crane hooks)
- Superior resistance to wear due to unique heat treatment.

Product Code	WLL (kg)	Size (mm)	S (mm)	R Pitch (mm)	F Outside Width (mm)	Weight (kg/m)	Finish	UOM	Metres Per 100kg	Metres Per 500kg Drum
	1400	6	6	18	21.6	0.96	Painted	Metre	104	520
	2500	8	8	24	28.8	1.57	Painted	Metre	64	320
	4000	10	10	30	36.0	2.46	Painted	Metre	40	200
	6700	13	13	39	46.8	4.18	Painted	Metre	24	120
	10000	16	16	48	57.6	6.28	Painted	Metre	15.9	79.5
	16000	20	20	62	70.5	8.90	Painted	Metre	11.2	56
	19000	22	22	66	79.2	11.88	Painted	Metre	8.2	41
	26500	26	26	78	94.1	16.18	Painted	Metre	6.18	30.9

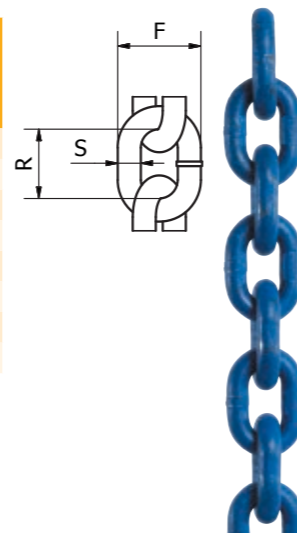

\*Most popular Grade 100 fittings

BV-100 Grade 100 Master Link\*

Product Code	Chain Size (mm)		WLL (kg)	S (mm)	R (mm)	F (mm)	T (mm)	Approx Weight (kg)	UOM	Pack Qty
	1 Leg	2 Leg								
	5	5	1730	11	90	65	10	0.22	Each	25
	6.7	7	2400	14	120	70	10	0.44	Each	16
	8	7	3300	16	140	80	13	0.67	Each	8
	10	8	4300	19	160	95	14	1.09	Each	6
	13	10	6900	23	160	110	17	1.69	Each	3
	16	13	11600	27	190	110	20	2.65	Each	2
	20	16	17300	33	230	130	26	4.78	Each	1
	22	20	27700	38	275	150	29	7.48	Each	1

Designed for Single & 2 Leg Applications

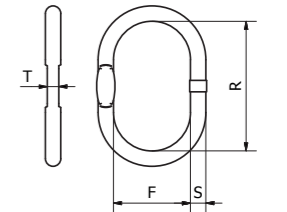

BV-100 Grade 100 Master Link\*

Product Code	Chain Size (mm)		WLL (kg)	S (mm)	R (mm)	F (mm)	T (mm)	Approx Weight (kg)	UOM	Pack Qty
	1 Leg	2 Leg								
	8	7	3500	16	110	60	14	0.53	Each	1
	10	8	5000	19	135	75	14	0.92	Each	1
	13	10	7600	23	160	90	17	1.6	Each	1
	16	13	10000	27	180	100	20	2.46	Each	1
	19	16	14000	33	200	110	26	4.14	Each	1
	22	19	25100	36	260	140	-	6.22	Each	1
	26	22	30800	45	340	180	-	12.82	Each	1
	32	26	40000	50	350	190	-	16.55	Each	1

Designed for Single & 2 Leg Applications

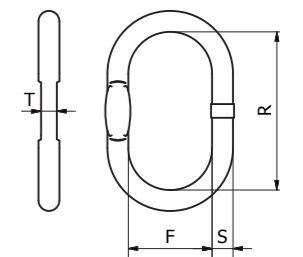

BV-100 Grade 100 Large Master Link\*

For use with large Ram Horn Hooks. c/w Intermediate Rings for Chain Slings.

Product Code	Chain Size (mm)	WLL @60 (kg)	S (mm)	E (mm)	R (mm)	F (mm)	T (mm)	s (mm)	r (mm)	f (mm)	t (mm)	Approx Weight (kg)	UOM	Pack Qty
	8	5600	27	410	340	180	20	13	54	25	10	5.1	Each	1
	10	9500	33	425	340	180	27	17	70	34	14	8	Each	1
	13	14000	40	455	340	180	29	20	85	40	-	12.3	Each	1
	16	21200	40	480	340	180	29	23	115	50	17	13.8	Each	1

Designed for 2, 3 & 4 Leg Applications

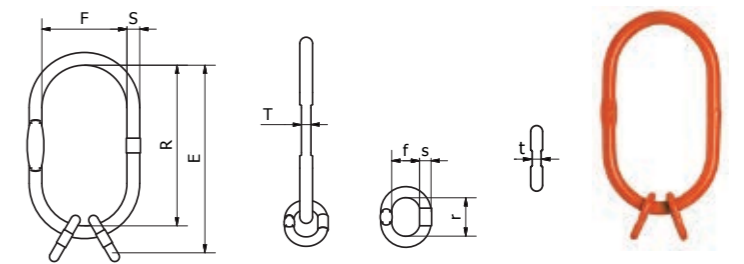

\*Most popular Grade 100 fittings

## Master Links and Sets for Grade 100 Assembly Systems

### BV-100 Grade 100 Multi-Leg Master Link Assembly\*

Product Code	Chain Size (mm)	WLL @60 (kg)	S (mm)	E (mm)	R (mm)	F (mm)	T (mm)	s (mm)	r (mm)	f (mm)	t (mm)	Approx Weight (kg)	UOM	Pack Qty
	7-8	7600	23	230	160	90	17	17	70	34	14	2.32	Each	1
	10	9600	27	265	180	100	20	20	85	40	14	3.68	Each	1
	13	14000	33	315	200	110	26	23	115	50	17	6.46	Each	1
	16	21200	36	400	260	140	-	27	140	65	20	10.06	Each	1
	19-20	34100	50	500	350	190	-	33	150	70	26	22.87	Each	1
	22	40000	50	520	350	190	-	36	170	75	-	24.79	Each	1
	26	56000	60	570	400	200	-	45	170	80	-	41.31	Each	1

Designed for 2, 3 & 4 Leg Applications

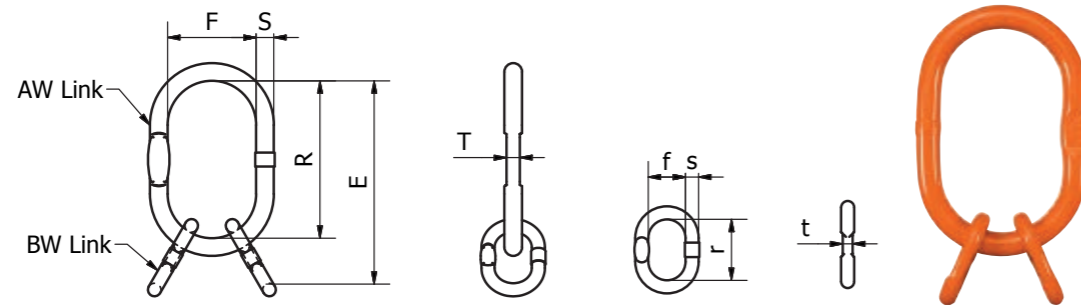

### BV-100 Grade 100 Enlarged Multi-Leg Master Link Assembly

Product Code	Chain Size (mm)	WLL @60 (kg)	S (mm)	E (mm)	R (mm)	F (mm)	T (mm)	s (mm)	r (mm)	f (mm)	t (mm)	Approx Weight (kg)	UOM	Pack Qty
	8	6600	23	230	160	110	17	17	70	34	14	2.41	Each	1
	10	10100	27	275	190	110	20	20	85	40	14	4.01	Each	1
	13	15700	33	345	230	130	26	23	115	50	17	6.9	Each	1
	16	21200	38	415	275	150	29	27	140	65	20	11.12	Each	1
	20	34100	56	500	350	250	-	33	150	70	26	28.08	Each	1
	22	40000	56	520	350	250	-	36	170	75	-	30.62	Each	1

Designed for 2, 3 & 4 Leg Applications

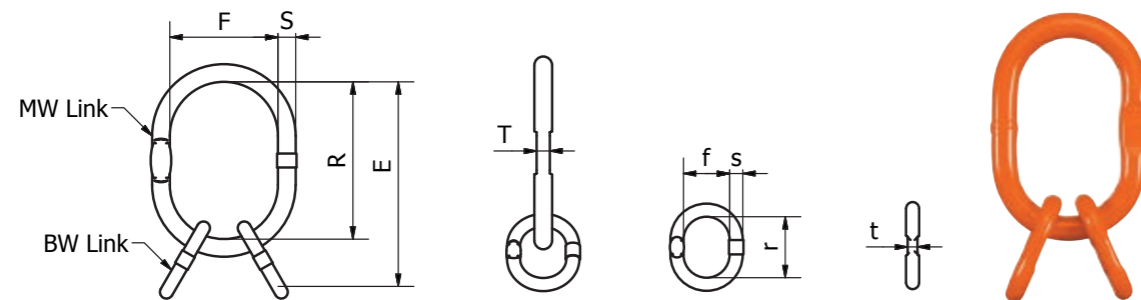

\*Most popular Grade 100 fittings

## Grade 100 Connectors

### BV-100 Grade 100 Connecting Link\*

Product Code	Chain Size (mm)	WLL (kg)	e (mm)	c (mm)	s (mm)	d (mm)	b (mm)	g (mm)	Approx Weight (kg)	UOM	Pack Qty	Replacement Bolt Kit
	6	1400	44	8	11	8	39	14	0.06	Each	20	CBHW6
	8	2500	62	12	15	10	53	18	0.18	Each	20	CBHW8
	10	4000	72	13	18	13	63	23	0.33	Each	30	CBHW10
	13	6700	88	19	22	17	79	28	0.7	Each	20	CBHW13
	16	10000	103	21	29	21	106	33	1.4	Each	12	CBHW16
	20	16000	115	30	35	25	118	42	2.14	Each	8	CBHW20
	22	19000	161	34	39	25	148	51	4.15	Each	6	CBHW22
	26	26500	190	40	46	30	175	60	6.7	Each	4	CBHW26

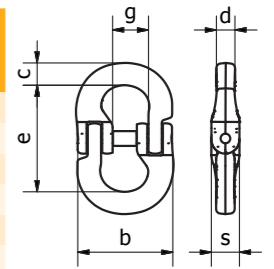

### BV-100 Grade 100 Round Sling Connecting Link

Product Code	Chain Size (mm)	WLL (kg)	e (mm)	c (mm)	g (mm)	h (mm)	a (mm)	b (mm)	d (mm)	s (mm)	Approx Weight (kg)	UOM	Pack Qty	Replacement Bolt Kit
	8	2500	66	12	18	91	29	65	10	18	0.3	Each	20	CBHW8
	10	4000	81	13	23	112	40	82	13	21	0.5	Each	30	CBHW10
	13	6700	104	19	28	144	50	100	17	28	1.1	Each	20	CBHW13
	16	10000	113	21	33	164	47	110	21	40	2	Each	12	CBHW16
	22	19000	178	29	48	250	109	215	27	59	6.5	Each	6	CBHW22

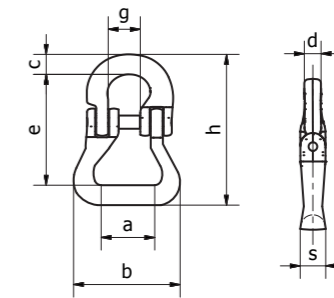

\*Most popular Grade 100 fittings

## BV-100 Grade 100 Hooks



The design of the clevis shortening grab hooks allow for a quick visual check that the chain is seated in the hook's mouth correctly. The design of the hook means that the supported chain no longer contacts the bearing surface of the hook, due to the chain being supported by the side faces of the hook. Meaning no deration of the rated capacity.

For shortening and for slings that must not tighten, these are the first Grade 100 clevis grab hooks on the market that do not require reduction in load capacity.



### BV-100 Grade 100 Clevis Grab Hook\*

Product Code	Chain Size (mm)	WLL (kg)	e (mm)	b (mm)	d (mm)	g (mm)	Approx Weight (kg)	UOM	Pack Qty	Replacement Pin Kit
6	1400	45	47	7	8	0.19	Each	80	KBSW 5/6	
8	2500	61	58	10	115	0.38	Each	55	KBSW 8	
10	4000	76	76	13	13	0.85	Each	25	KBSW 10	
13	6700	104	101	16	17	1.9	Each	12	KBSW 13	
16	10000	116	120	20	20	3.6	Each	8	KBSW 16	
20	16000	141	150	24	25	6.15	Each	4	KBSW 19/20	
22	19000	158	165	27	27	9	Each	3	KBSW 22	

No Deration

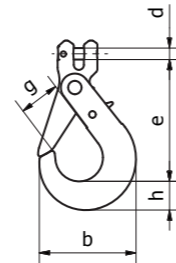
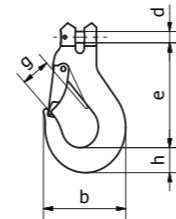
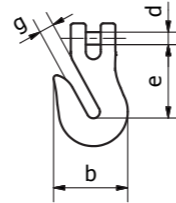

### BV-100 Grade 100 Clevis Self Locking Hook\*

Product Code	Chain Size (mm)	WLL (kg)	e (mm)	h (mm)	b (mm)	d (mm)	g (mm)	Approx Weight (kg)	UOM	Pack Qty	Replacement Pin Kit
8	2500	123	26	88	10	34	0.9	Each	25	VLHW7/8	
10	4000	144	30	107	13	45	1.6	Each	12	VLHW10	
13	6700	180	40	138	16	52	2.9	Each	6	VLHW13	
16	10000	218	50	168	20	60	5.8	Each	4	VLHW16	
20	16000	260	62	194	24	70	10	Each	3	VLHW20/22	
22	19000	284	65	211	27	81	12.8	Each	1	VLHW20/22	
26	26500	339	79	253	33	100	21	Each	1	VLHW26	

\*Most popular Grade 100 fittings

## Grade 100 Hooks

### BV-100 Grade 100 Eye Shortening Grab Hook\*

Product Code	Chain Size (mm)	WLL (kg)	e (mm)	b (mm)	d1 (mm)	d2 (mm)	g (mm)	Approx Weight (kg)	UOM	Pack Qty
7-8	2500	71	58	20	12	11	0.4	Each	80	
10	4000	88	76	22	15	13	0.9	Each	30	
13	6700	113	101	26	18	17	1.8	Each	15	
16	10000	129	118	32	23	19	3.6	Each	8	
20	16000	151	150	36	27	25	6.15	Each	5	
22	19000	170	165	42	31	27	8.3	Each	3	
26	26500	201	195	50	37	32	13.8	Each	2	

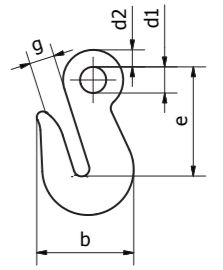

Used for the shortening of chain sling legs. It's the first grab hook in grade 100 on the market. Due to its unique design there is no deration in the load capacity. This is due to the four fold feature of the hooks supporting cradle design.

No Deration

### BV-100 Grade 100 Eye Sling Hook c/w Safety Catch\*

Product Code	Chain Size (mm)	WLL (kg)	e (mm)	h (mm)	d1 (mm)	d2 (mm)	g (mm)	b (mm)	Approx Weight (kg)	UOM	Pack Qty	Replacement Latch Kit
7-8	2500	106	27	25	11	26	88	0.5	Each	30	SFGW7/8	
10	4000	131	33	34	16	31	109	1.1	Each	18	SFGW10	
13	6700	164	44	43	19	39	134	2.2	Each	10	SFGW13	
16	10000	183	50	50	25	45	155	3.5	Each	5	SFGW16	
20	16000	205	55	55	27	53	178	5.8	Each	3	SFGW20	
22	19000	225	62	60	29	62	196	8	Each	2	SFGW22	
26	26500	259	75	70	37	73	235	12.8	Each	1	SFGW26-32	

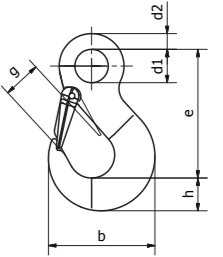

\*Most popular Grade 100 fittings

## Grade 100 Hooks

### BV-100 Grade 100 Safety Eye Self Locking Hook\*

Product Code	Chain Size (mm)	WLL (kg)	e (mm)	h (mm)	b (mm)	d1 (mm)	d2 (mm)	g (mm)	Approx Weight (kg)	UOM	Pack Qty	Replacement Pin Kit
	7-8	2500	136	26	88	25	12	34	0.9	Each	25	VLHW7/8
	10	4000	169	30	107	35	15	45	1.5	Each	12	VLHW10
	13	6700	205	40	138	40	20	52	2.7	Each	8	VLHW13
	16	10000	251	50	168	50	27	60	5.7	Each	4	VLHW16
	20	16000	290	62	194	60	30	70	9.8	Each	3	VLHW19-20
	22	19000	322	65	211	70	32	81	12.4	Each	1	VLHW22

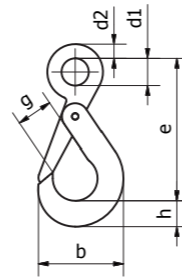

### BV-100 Grade 100 Swivel Self Locking Hook

Product Code	Chain Size (mm)	WLL (kg)	d2 (mm)	c (mm)	h (mm)	g (mm)	w (mm)	g1 (mm)	Approx Weight (kg)	UOM	Pack Qty
	6	1400	13	160	20	28	35	0.6	Each	20	VLHW6
	8	2500	13	181	26	34	35	1.1	Each	15	VLHW7/8G
	10	4000	16	218	30	45	42	2	Each	8	VLHW10
	13	6700	20	269	40	52	49	4	Each	6	VLHW13
	16	10000	24	319	50	60	60	6.8	Each	2	VLHW16

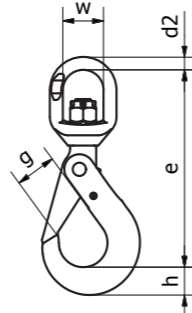

### BV-100 Grade 100 Eye Foundry Hook

Product Code	Chain Size (mm)	WLL (kg)	c (mm)	h (mm)	d1 (mm)	d2 (mm)	g (mm)	b (mm)	Approx Weight (kg)	UOM	Pack Qty
	10	4000	158	35	31	14	76	143	1.77	Each	8
	13	6700	190	42	39	17	89	170	2.82	Each	5
	16	10000	224	50	47	22	102	200	5.03	Each	3
	20	16000	260	61	56	28	114	231	7.6	Each	2

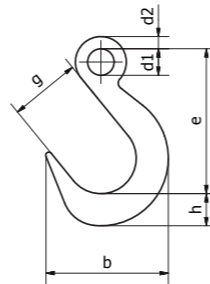

\*Most popular Grade 100 fittings

## Grade 100 Weld-on Lifting and Lashing Rings



Suitable for the mining, offshore exploration, road or rail transport and maritime industries.

### Features

- Grade 100 Quality Alloy Steel, quenched and tempered
- Offers a full working load limit at all angles
- Extremely high strength attachment
- Lifting ring and welding block are both marked for accurate traceability

- 100% magnetically crack inspected (MPI)
- Easily welded into required position with the aid of height lugs on the weld block
- Lifting ring has durable powder coated baked enamel finish
- Test certificate available.

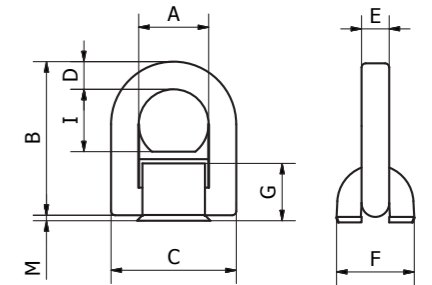
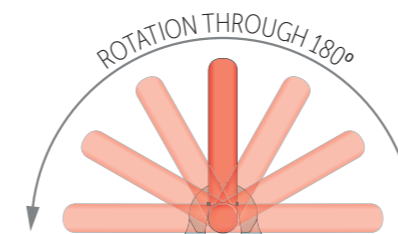

Product Code	WLL (kg)	A (mm)	B (mm)	C (mm)	D (mm)	E (mm)	F (mm)	G (mm)	I (mm)	M (mm)	Weld mm HV+aL	Weight (kg)
	1500	38	79	66	14	13.5	32	25	31	2	HV5+3	0.40
	4000	51	102	87	18	16.5	42	32	40.5	2	HV7+3	0.60
	6700	67	138	115	24	22.5	61	44	55	4	HV8+3	0.90
	10000	67.5	142	129	26.5	27.5	75	53	57.5	4	HV12+4	2.0
	10000	67.5	142	129	26.5	27.5	75	53	57.5	4	HV16+4	3.0
	16000	100	215	190	40	26	95	69	85	5	HV25+6	6.9

\*Most popular Grade 100 fittings

## Bolt-on Rotating Lifting and Lashing Point - Grade 100



The ERLP rotating, bolt-on lifting and lashing points offer the ideal solution for lifting or load lashing when a permanent or semi-permanent point is required. Their slim line design fits in confined spaces.

Easy to fit with the hexagonal screw, the ERLP is able to rotate 360 degrees and articulate 180 degrees. It is forged in Grade 100 material and features a dismantlable open D-ring.

Suitable for the mining, heavy construction, road or rail transport or maritime industries.

Product Code	L (mm)	M (mm)	B (mm)	D (mm)	C (mm)	H (mm)	Y (mm)	Weight (kg)
ERLP-M8-10	15	M8	Ø27	10	20	63	52	0.257
ERLP-M10-10	20	M10	Ø27	10	20	63	52	0.268
ERLP-M12-10	19	M12	Ø38	15	31	91.8	73	0.772
ERLP-M16-10	24	M16	Ø38	15	31	91.8	73	0.8

\*Most popular Grade 100 fittings

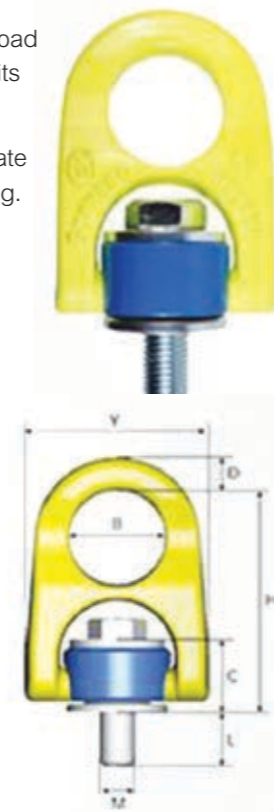

# RUD ICE 120 LIFTING CHAIN & FITTINGS

## RUD ICE 120 Lifting Chain & Fittings



RUD lifting and lashing chains and components offer superior wear resistance and provide multi-directional load and lift options that maximise safety without compromising on strength.

RUDs ICE 120 chain and fittings offer considerable weight deduction, improved ergonomics, easier assembly and increased safety.

### ICE 120 delivers improved performance

ICE 120 offers a higher level of performance in notch impact strength, breaking strain and fatigue strength - all at a full chain diameter smaller than Grade 80 equivalents:

- 60% increase in Working Load Limit which means that the same load can now be lifted by a chain one full diameter size smaller;
- 30% increase in surface hardness which means replacement costs can be reduced;
- 30% lighter chain which is easier and safer to handle, and more economical to use;
- Increase in notch impact strength to more than 55 Joule which guarantees safe use in temperatures from -60 °C to +300 °C;
- A special fluorescent purple powder coating which permanently changes colour when the chain has been exposed to extreme temperatures.

### An extensive range of chain sizes and components

ICE 120 chains are available in sizes from 6 mm to 16 mm; with a full range of master links, hooks, connectors, shortening devices supplied. At Bunzl Safety we can provide fully assembled chain slings to your specific requirements.

RUD ICE 120 Chain and Components conform fully to the requirements of EN 818 and 1677 for dynamic applications of 20,000 load cycles, with 50% over load.

	The high quality ICE-chains and components get a special ICE-Pink-Powder Coating (colour: traffic purple).	Due to the double coating system (pre-treatment and ICE-Pink-Powder Coating) there is a considerably better surface protection than with an oiled or galvanized finished chain.																		
	Due to FEM-supported design construction optimising, up to 25 % less weight than the next larger hook in Grade 80 with the same throat opening and base thickness.	<table border="1"> <thead> <tr> <th>Grade</th> <th>8</th> <th>12</th> </tr> </thead> <tbody> <tr> <td>Chain Ø</td> <td>13</td> <td>16</td> </tr> <tr> <td>WALL/kg</td> <td>5000</td> <td>5000</td> </tr> <tr> <td>Throat opening/mm</td> <td>40</td> <td>40</td> </tr> <tr> <td>Base thickness/mm</td> <td>37</td> <td>37</td> </tr> <tr> <td>Weight/kg</td> <td>2.5</td> <td>1.7</td> </tr> </tbody> </table>	Grade	8	12	Chain Ø	13	16	WALL/kg	5000	5000	Throat opening/mm	40	40	Base thickness/mm	37	37	Weight/kg	2.5	1.7
Grade	8	12																		
Chain Ø	13	16																		
WALL/kg	5000	5000																		
Throat opening/mm	40	40																		
Base thickness/mm	37	37																		
Weight/kg	2.5	1.7																		
	<b>Foot-proof:</b> • Every link is stamped with ICE on the reverse side. • Every component is clearly marked with ICE	<ul style="list-style-type: none"> <li>• Colour: ICE-Pink → traffic purple</li> <li>• Clear distinction compared with VIP-Magenta Pink Grade 100 and Grade 80 Red</li> </ul>																		
	• Master links with a 40° sloped flattening...	... only with ICE – suitable for the assembly of the ICE-Connector and the ICE-Shortening Coupler!																		



## Working Load Limits Grade 120

Chain Size (mm)	Single Leg Slings				Slings of 2,3 or 4 Leg Slings			2 Leg Slings		
	Straight Sling	Adjustable Sling	Reeved Sling	Basket Sling Max 60°	60° Max	90°	120°	Reeved Sling 60°	Basket Sling Max 60°	60° Max
6	1.8	1.8	1.4	2.3	3.1	2.5	1.8	2.3	4.1	
8	3.0	3.0	2.3	3.9	5.2	4.2	3.0	3.9	6.8	
10	5.0	5.0	3.8	6.5	8.7	7.1	5.0	6.5	11.3	
13	8.0	8.0	6.0	10.4	13.8	11.3	8.0	10.4	18.0	
16	12.5	12.5	9.4	16.3	21.6	17.6	12.5	16.3	28.1	

Working load limit in tonnes of 1000kg under general conditions of use. Some grab hooks derate the W.L.L. by 25%. Shortening hooks and cradle grab hooks may not derate the W.L.L. Advice should be sought from the manufacturer.

## RUD ICE Grade 120 Chain Slings



As with the Grade 100 Pre-made Chain Slings, Bunzl Safety can provide RUD Grade 120 chain slings made to order for your convenience.

The Grade 120 Chain Slings conform to EN818 and 1677.

The RUD Grade 120 Chain has a more intelligent profile which increases both fatigue and bending resistance.

### ICE Grade 120 Assembled Chain Slings/Clevis Sling Hook: Unit of Measure - Each

- Manufactured in standard lengths, other lengths available
- Fully assembled with clevis sling hook
- Includes clevis grab hook, stainless steel tag and test certificate.



RUD Part No.	Chain Size (mm)	No. of Legs	WLL (t)	Leg Length (m)
7771081	8	1	3.0	1
7771082	8	1	3.0	2
7771083	8	1	3.0	3
7771084	10	1	5.0	1
7771085	10	1	5.0	2
7771086	10	1	5.0	3
7771087	13	1	8.0	3
7771088	13	1	8.0	6
7771089	8	2	5.2 @ 60°	1
7771090	8	2	5.2 @ 60°	2
7771091	8	2	5.2 @ 60°	3
7771092	10	2	8.6 @ 60°	1
7771093	10	2	8.6 @ 60°	2
7771094	10	2	8.6 @ 60°	3
7771095	10	2	8.6 @ 60°	4
7771096	10	2	8.6 @ 60°	6
7771097	13	2	13.8 @ 60°	3
7771098	13	2	13.8 @ 60°	6







# CROMOX GRADE 60 STAINLESS STEEL CHAIN SLINGS

## CROMOX Grade 60 Stainless Steel Chain Slings

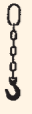
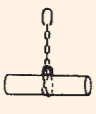
Cromox Chain Slings and Accessories from Ketten Walder provide safety for demanding lifting and heavy-duty transports with superior protection against corrosion in harsh environments and increased longevity. Cromox chain slings are designed in Germany for superior safety and durability.

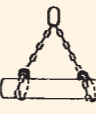
### Ring-and hook-ended Slings similar DIN 5688-1 Grade 60

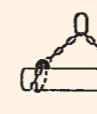
Method of lifting Angle of inclination	W.L.L. in (t)					
	1-Leg		2-Leg, 3-Leg & 4-Leg			
	Direct	Tied	Direct	Tied	Direct	Tied
Nominal chain thickness acc. to DIN 5687						
4	0.35	0.30	0.50	0.40	0.35	0.30
5	0.60	0.45	0.85	0.65	0.60	0.45
6	0.90	0.70	1.25	1.00	0.90	0.70
7	1.20	0.95	1.65	1.35	1.20	0.95
8	1.50	1.20	2.10	1.65	1.50	1.20
10	2.40	1.90	3.35	2.70	2.40	1.90
13	3.85	3.10	5.40	4.30	3.85	3.10
16 (G5)	5.00	4.00	7.00	5.60	5.00	4.00
18 (G5)	7.00	5.60	9.80	7.80	7.00	5.60

The above-mentioned working load limits correspond approximately to the following load factors:  
 1.00      0.80      1.40      1.12      1.00      0.80



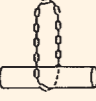
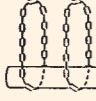
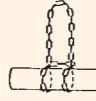
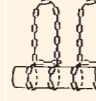

The strain must be reduced to 50 % of the W.L.L. for unbalanced lifting.

Dependent on chain type and method of lifting.  
 Note: Slings ending in Shackles may need to be de-rated to Grade 50 in some cases.

### Loop chains vertically hanging

Method of lifting Angle of inclination	W.L.L. in (t)			
	Direct 0°	Direct 0°	Tied 0°	Tied 0°
Nominal chain thickness acc. to DIN 5687				
4	0.70	1.40	0.55	1.10
5	1.20	2.40	0.95	1.90
6	1.80	3.60	1.45	2.85
7	2.40	4.80	1.90	3.85
8	3.00	6.00	2.40	4.80
10	4.80	9.60	3.85	7.70
13	7.70	15.40	6.20	12.30
16 (G5)	10.00	20.00	8.00	16.00
18 (G5)	14.00	28.00	11.20	22.40

### Basket chain with Master Link

W.L.L. in (t)			
90°	120°	90°	120°
			
0.50	0.40	0.75	0.55
0.85	0.65	1.25	0.90
1.25	1.00	1.90	1.35
1.65	1.35	2.50	1.80
2.10	1.65	3.15	2.25
3.35	2.70	5.00	3.60
5.40	4.30	8.10	5.80
7.00	5.60	10.00	7.50
9.80	7.80	14.70	10.50

The above-mentioned working load limits correspond approximately to the following load factors:

2.00      2x2      1.60      3.20      1.40      1.12      2.10      1.50

In (presumably arising) bending stresses the working load must be reduced as follows:

1.60      2 x 1.60      1.10      0.80      1.70      1.20

The strain must be reduced to 50 % of the W.L.L. for unbalanced lifting.

Dependent on chain type and method of lifting.

## Electrolytic Polished Finish



Electrolytic polishing reduces the micro-roughness of the chain, thereby reducing dirt and enabling the chain to be more easily cleaned and further resistant to corrosion.

CROMOX Chain Slings Grade 60 similar  
 DIN 5688-1 Sand blasted



Type	Chain W.L.L.	Dimensions mm				Weight
	t	d	t	b <sub>1</sub> min	b <sub>2</sub> max	kg
*CK 4	0.35	4.0	12.0	5.0	13.7	0.350
KW-CK5	0.60	5.0	15.0	6.5	18.5	0.540
KW-CK6	0.90	6.0	18.0	7.8	22.2	0.800
KW-CK7	1.20	7.0	21.0	9.1	25.9	1.100
KW-CK8	1.50	8.0	24.0	10.4	29.6	1.400
KW-CK10	2.40	10.0	30.0	13.0	37.0	2.200
KW-CK13	3.85	13.0	39.0	16.9	48.1	3.800
KW-CK16 (G5)	5.00	16.0	48.0	20.8	59.2	5.700
*CK 18 (G5)	7.00	18.0	54.0	24.3	64.8	7.300

\*On Request.

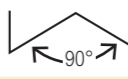

This section on Request.

### CROMOX Loop Chains CELK. Grade 60 bright polished

Type	W.L.L. vertical t	W.L.L. t	W.L.L. t
			
CELK 4	0.70	0.50	0.40
CELK 5	1.20	0.85	0.65
CELK 6	1.80	1.25	1.00
CELK 7	2.40	1.65	1.35
CELK 8	3.00	2.10	1.65
CELK 10	4.80	3.35	2.70
CELK 13	7.70	5.40	4.30
CELK16 (G5)	10.00	7.00	5.60

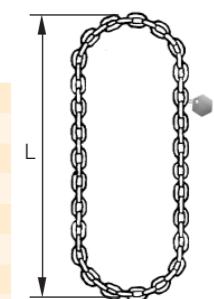

L = Length 1000 mm Circumference 2000 mm

**Note:**  
 Custom sizes and finishes upon request

### Working Load Limit dependent on chain temperature

450°C	-40°C to +250°C	over 250°C to 350°C*	over 350°C to 450°C
W.L.L.	100%	75%	50%

\*1.4462 (AISI 318LN) max 350°C allowed



## CROMOX Oblong Master and Sub-Assembly with Flattened Section

All master links have a flattened section to allow the use of connectors (e.g. clevis shackles type CGS)

CROMOX Oblong Master CAGF. Grade 60 for 1- and 2-leg chain slings. Sand blasted

Type	W.L.L.		for Chain		Dimensions mm			Weight kg
	t		1 – leg	2 – leg	d	t	b	
*KW-CAGF10	0.60		5	4	10	80	50	0.150
KW-CAGF13	1.50		6/7/8	5/6	13	110	60	0.340
KW-CAGF16	2.40		10	7/8	16	110	60	0.530
KW-CAGF18	3.35		–	10	18	135	75	0.800
KW-CAGF22	6.00		13/16	13	22	160	90	1.500
KW-CAGF26	8.00		18	16	26	180	100	2.300
KW-CAGF32	12.00		20	18	32	200	110	3.900
*KW-CAGF36	16.00		–	20	36	260	140	6.350

**\*On Request. \*Angle of indination 90°**

CROMOX Sub-Assembly CAKF. Grade 60 for 3- and 4-leg chain slings. Sand blasted

Type	W.L.L.		for Chain	Dimensions mm			Weight kg
	90°	120°		d	t	b	
*CAKF13/10	1.25	0.90	5	A 13 B 10	110 44	60 25	0.520
KW-CAKF16/13	2.50	1.80	6	A 16 B 13	110 54	60 25	0.970
KW-CAKF18/16	3.15	2.25	7/8	A 18 B 16	135 70	75 34	1.600
KW-CAKF22/16	5.00	3.60	10	A 22 B 18	160 85	90 40	2.760
*CAKF26/22	8.00	5.70	13	A 26 B 22	180 115	100 50	4.450
*CAKF32/26	10.00	7.50	16	A 32 B 26	200 140	110 65	7.550

**\*On Request.**

CROMOX Sub-Assembly CAKF. Grade 50 for 3- and 4-leg chain slings. Sand blasted

Type	W.L.L.		for Chain	Dimensions mm			Weight kg
	90°	120°		d	t	b	
KW-178622BK	1.70	1.25	8	A 22 B 16	160 70	90 34	2.300
KW-178626BK	2.80	2.00	10	A 26 B 18	180 85	100 40	3.560

CROMOX®

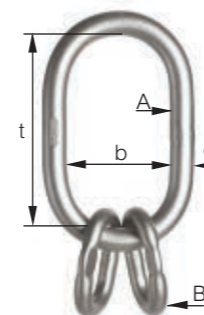
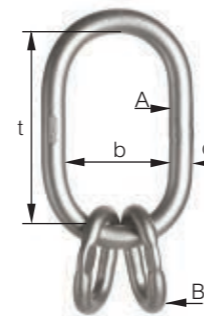
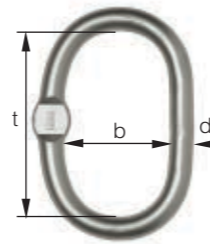

## CROMOX Oblong Master and Sub-Assembly without Flattened Section

CROMOX®

CROMOX Sub-Assembly for Ropes CAKS. Grade 60 blasted

**New**

Type	W.L.L. t		Dimensions mm			Weight ca.kg
	45°	60°	d	t	b	
CAKS16/13	1.80	1.25	A 16 B 13	110 110	60 60	1.210
CAKS16/16	2.40	1.70	A 16 B 16	110 110	60 60	1.590
CAKS18/16	3.25	2.25	A 18 B 16	135 110	75 60	1.860
CAKS22/18	5.00	3.50	A 22 B 18	160 135	90 75	3.100
CAKS26/22	8.50	5.95	A 26 B 22	180 160	100 90	5.400
CAKS32/26	10.75	7.50	A 32 B 26	200 180	110 100	8.500
CAKS36/32	13.60	9.50	A 36 B 32	260 200	140 110	14.150

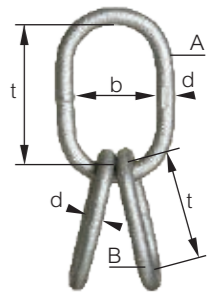

CROMOX Oblong Master CAG. Grade 60 1- and 2-leg. Sand blasted

Type	W.L.L.		for Chain		Dimensions mm			Weight kg
	t		1 – leg	2 – leg	d	t	b	
*CAG 8	0.30		4	–	8	54	30	0.070
KW-CAG10	0.60		5	4	10	80	50	0.150
KW-CAG13	1.50		6/7/8	5/6	13	110	60	0.340
*CAG 16	2.40		10	7/8	16	110	60	0.530
*CAG 18	3.35		–	10	18	135	75	0.800
*CAG 22	6.00		13/16	13	22	160	90	1.500
*CAG 26	8.00		18	16	26	180	100	2.300
*CAG 32	12.00		20	18	32	200	110	2.900
*CAG 36	16		–	20	36	260	140	6.350

**\*On Request.**

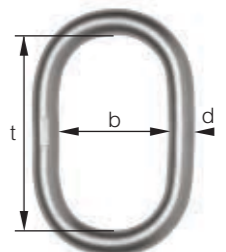

This section on Request. CROMOX Sub-Assembly CAK. Grade 60 3- and 4-leg. Sand blasted

Type	W.L.L. t		for Chain	Dimensions mm			Weight kg
	90°	120°		d	t	b	
CAK 10/ 8	0.75	0.55	4	A10 B 8	80 35	50 19	0.240
CAK 13/10	1.25	0.90	5	A13 B10	110 44	60 25	0.520
CAK 16/13	2.50	1.80	6/7	A16 B13	110 54	60 25	0.970
CAK 18/16	3.15	2.25	8	A18 B16	135 70	75 34	1.600
CAK 22/18	5.00	3.60	10	A22 B18	160 85	90 40	2.760
CAK 26/22	8.00	5.70	13	A26 B22	180 115	100 50	4.450
CAK 32/26	10.00	16	16	A32 B26	200 140	110 65	7.550

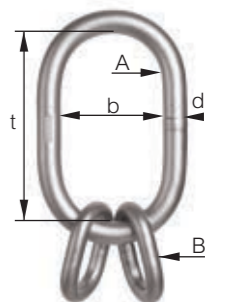

## CROMOX Clevis Hooks, Eye Hooks and Accessories

CROMOX Clevis Hooks CGHF. Grade 60 with safety latch. Sand blasted

Type	W.L.L.	Dimensions mm				Weight
	t	t	g	h	kg	
*CGHF 05	0.60	79	25	22	0.400	
KW-CGHF 06	0.90	78	25	22	0.400	
KW-CGHF07/08	1.50	97	32	28	0.760	
KW-176610GB	2.40	121	41	34	1.440	
*KW-176613GB	3.20	143	48	47	2.600	
*KW-176616GB	5.00	180	69	57	4.900	

\*Discontinued Line

CROMOX®

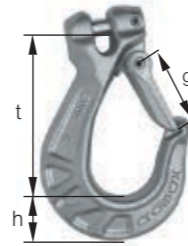

CROMOX Eye Hooks COHF. Grade 60 with safety latch. Sand blasted

Type	W.L.L.	Dimensions mm					Weight
	t	t	g	b	h	kg	
*COHF 04	0.40	75	20	17	17	0.185	
KW-COHF05/06	0.90	100	25	25	22	0.350	
KW-175608GB	1.25	126	32	27	28	0.790	
KW-175610GB	2.00	160	39	37	34	1.370	
KW-175613GB	3.20	190	51	48	45	3.000	
*COHF 16 (G5)	5.00	230	66	55	51	4.800	
*COHF 18 (G5)	7.00	230	66	55	51	4.800	

\*On Request.



CROMOX Swivel Load Hooks with eyelet CWHB. Grade 60 blasted

**New**

Type	W.L.L.	Dimensions mm					Weight
	t	t	g	b	h	kg	
CWHB 4/5	0.63	120	20	40	16.0	0.650	
CWHB 6/7	1.25	165	25	49	21.0	0.988	
CWHB 8/10	2.50	235	40	64	33.0	2.710	

### Advantages:

- Duplex material 1.4462 (AISI 318LN) ensures superior corrosion resistance
- Ball bearings allow easy rotation even under full load
- Large eyelet dimensions for multiple applications
- Patented Skeletto design guarantees high admissible loads
- Flattened section on the eyelet enables combination with cromox Clevis Shackles CGS.

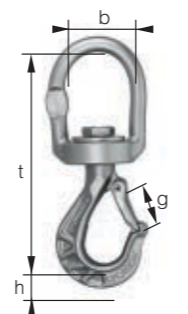

## CROMOX Clevis Hooks, Eye Hooks and Accessories

CROMOX®

CROMOX Safety Latch Assembly CSG for CGHF & COHF. Sand blasted

CROMOX Bolts and Pins CBP for CGHF & CGS. Bright polished

Type	Weight
	kg
COHF 04	0.026
COHF 05 /06	0.030
COHF 07 /08	0.050
COHF 10	0.095
COHF 13	0.150
COHF 16 /18	0.250



Type	Dimensions mm	Weight
	d/l	kg
CBP 05	6 x 28	0.007
CBP 06	8 x 28	0.010
CBP 07	8 x 32	0.013
CBP 08	10 x 32	0.020
CBP 10	13 x 40	0.045
CBP 13	16 x 45	0.070
CBP 16	20 x 55	0.140

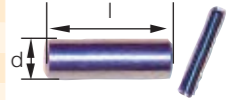

Heavy-duty hook constructed with an integrated forged safety latch.

The latch itself is highly resistant to side buckling. If the hook becomes overloaded the latch will disengage.

The hook point is designed to prevent usage with the incorrect chain size while ensuring that the safety latch does not reduce hook admittance.

CROMOX Clevis Shackles CGS. Grade 60 tested. Sand blasted

Type	W.L.L.	Dimensions mm				Weight
	t	t	b	a	kg	
KW-CGS 06	0.90	26	20	7	0.160	
KW-CGS 07/08	1.50	30	23	9	0.230	
KW-CGS 10	2.40	40	28	11	0.460	
KW-CGS 13	3.85	48	38	14	0.675	
KW-CGS 16 (G5)	5.00	50	44	17	1.130	

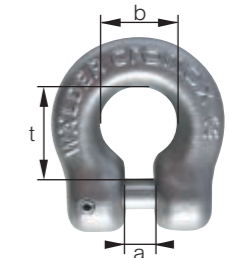

CROMOX Connecting Links CVG. Grade 60 tested. Blasted

**New**

Type	W.L.L.	Dimensions mm				Weight
	t	t	b	d	kg	
KW-CVG06	0.90	42	15	7.5	0.085	
KW-CVG07	1.25	42	15	9.5	0.090	
KW-CVG08	1.55	55	18	11.5	0.150	
KW-CVG10	2.45	90	28	18.0	0.310	

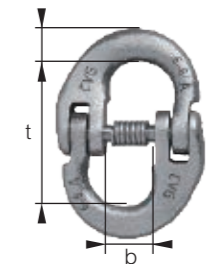

CROMOX D-Shackles CSA. Grade 50 tested. Bright polished

Type	W.L.L.	Dimensions mm					Weight
	t	a	d	t	b	kg	
KW-CSA04	0.30	7	6	23	12	0.035	
KW-CSA05	0.50	9	8	24	17	0.070	
KW-CSA06	0.75	11	10	35	20	0.135	
KW-CSA08	1.25	13	12	42	25	0.220	
KW-CSA10	2.00	18	16	64	32	0.510	
KW-CSA13	3.20	21	19	76	38	0.910	
KW-CSA16	5.00	19	16	64	32	0.910	
*CSA 18	7.00	22	19	76	38	0.550	
KW-184620EP	9.00	26	22	88	44	1.000	
*CSA 22	11.00	29	25	102	51	1.900	
*CSA 26	13.00	32	29	114	57	3.100	
*CSA 27	15.00	35	32	128	64	4.350	
*CSA 28	18.00	38	35	140	70	5.300	

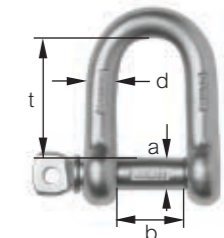

\*On Request.

# CROMOX Clevis Hooks, Eye Hooks and Accessories



CROMOX Safety Shackles CSS. Grade 50 tested. Bright polished

Type	W.L.L.	Dimensions mm					Weight
	t	a	d	t	b	kg	
KW-CSS04	0.30	7	6	23	12	0.035	
KW-CSS05	0.50	9	8	24	17	0.070	
KW-CSS06	0.75	11	10	35	20	0.135	
KW-CSS08	1.25	13	12	42	25	0.225	
KW-CSS10	2.00	18	16	64	32	0.540	
KW-CSS13	3.20	21	19	76	38	0.945	

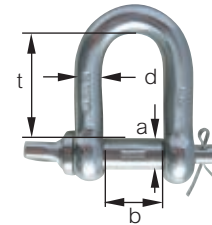

CROMOX Shorteners CV. Grade 50 tested. Sand blasted

Type	W.L.L.	Dimensions mm				Weight
	t	a	b	t	kg	
KW-194606	0.75	47	10	81	0.180	
KW-194608	1.25	70	12	94	0.380	
KW-194610	2.00	80	15	120	0.710	
KW-194613	3.85	91	20	150	1.180	
KW-CV16(G5)	5.00	100	21	175	2.300	



## CROMOX Pump Chains. Stainless Grade 60

Versatile Heavy-Duty Solutions

CROMOX pump chains enable safe lifting and lowering of pumps and aeration devices. Accompanied with WLL-tag and certificate. In addition to our standard sizes, we offer customized solutions.

- Two-leg system for pumps with 2 lifting points
- Selection of end-fittings such as eye hooks, joining links, or shackles
- Custom segment lengths by request.

CROMOX Pump Chains CPK. Grade 60 welded. Tested

Type	W.L.L.	Master Link	Chain	Joining link
	t	mm	mm	mm
*CPK 3	0.20	5 x 42 x 22	3 x 14	-
KW-CPK4	0.35	8 x 54 x 30	4 x 16	5 x 22 x 9
KW-CPK5	0.60	10 x 80 x 50	5 x 15	6 x 26 x 13
KW-CPK6	0.90	13 x 110 x 60	6 x 18	8 x 35 x 19
KW-CPK7	1.20	13 x 110 x 60	7 x 21	8 x 35 x 19
KW-CPK8	1.50	13 x 110 x 60	8 x 24	10 x 44 x 25
*CPK 9	2.00	13 x 110 x 60	9 x 27	10 x 44 x 25
KW-CPK10	2.40	16 x 110 x 60	10 x 30	13 x 54 x 25
KW-CPK13	3.85	22 x 160 x 90	13 x 39	16 x 70 x 34
*CPK 16 (G5)	5.00	22 x 160 x 90	16 x 48	18 x 85 x 40
*CPK 18 (G5)	7.00	26 x 180 x 100	18 x 54	22 x 115 x 50

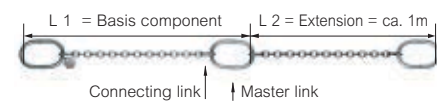

Fig.: Customized edition

Many sizes also available in Duplex!

**\*On Request.** Custom fittings and fabrications available  
Standard Length ≈ 1500 mm; other lengths by request  
L 1 = approximately 1m + one additional masterlink